

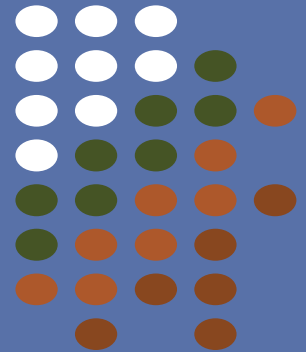

**CAMP PERKINS**  
*Lutheran Outdoor Ministries*

2023 Delegate  
Convention



# Welcome

---

Rev Mark Schulze

Board Chairman

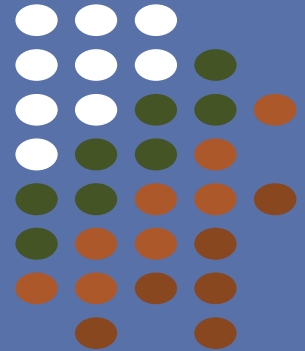



**CAMP PERKINS**

*Lutheran Outdoor Ministries*

# TED Talks: Camp Style

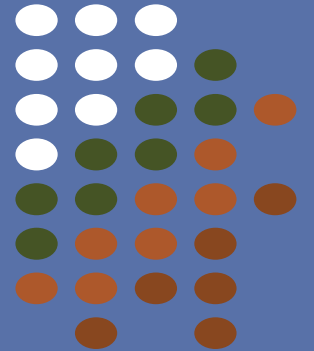

# Nette Miller, Trinity Eden Bacon Off Event

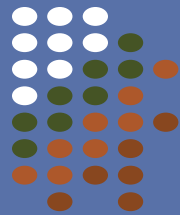



# Shawnee Rasmussen, Grace Pocatello Chili Cook-off

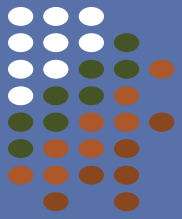

# Debbie Matsen, Trinity Rupert

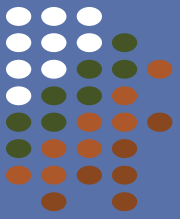

## Fundraisers for Camperships for Trinity Youth

### Pancakes for Perkins

### Poppin' to Perkins

# Sunday Morning Challenge Match Signe

St. John, Idaho Falls  
Friendship Celebration, Meridian

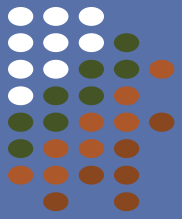

# Cassie Love, Pilgrim Ontario

## Communication to Congregation

## Fill the Tub Challenge

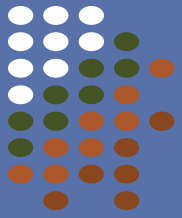
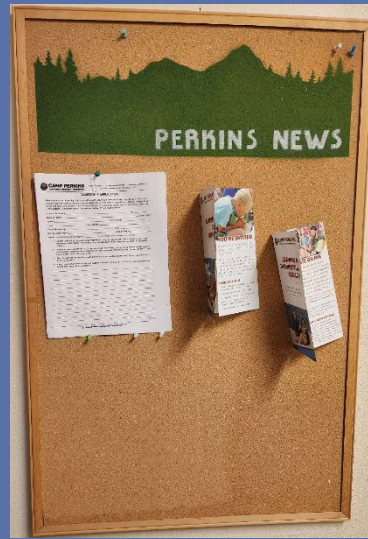



***May the God of hope  
fill you with all  
joy and peace  
as you trust in Him,  
so that you may  
overflow with hope  
by the power  
of the Holy Spirit.***

~Romans 15:13~





# CAMP PERKINS

*Lutheran Outdoor Ministries*

## Elections

Mark Schulze

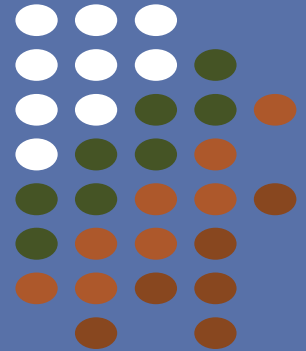

# Nominees

- Ben Anderson
- Aaron Jenkins
- Nancy Staffen

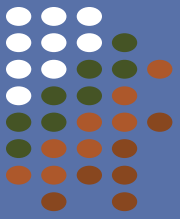



**Spring Work Weekend Turnout!**



**Summer Camp Fun...**



**Winter Family Flurry!**





**Camp Perkins draws people from  
their routines into creation and  
community experiences  
to make and nurture  
disciples for Christ.**

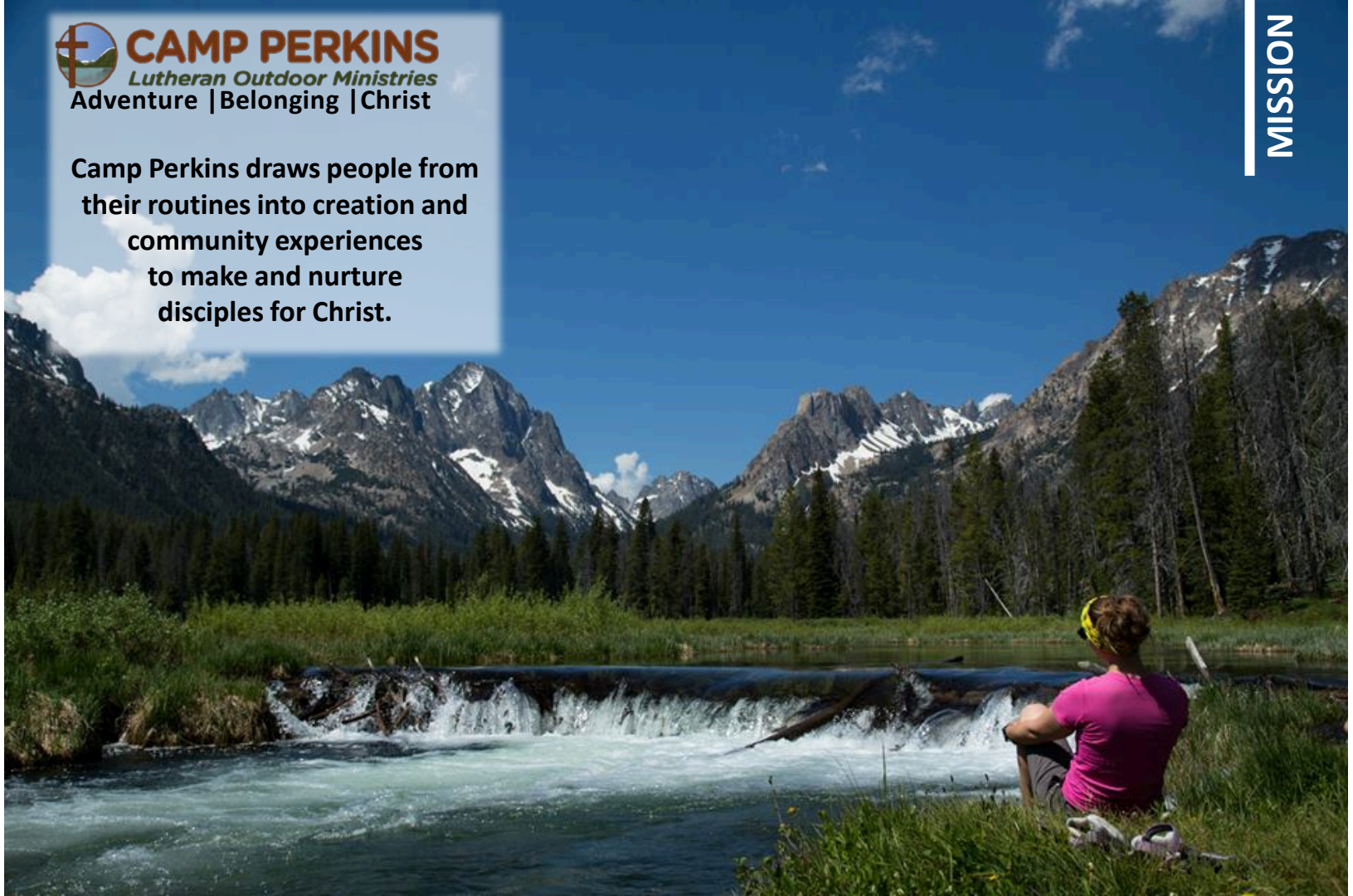



**CAMP PERKINS**  
*Lutheran Outdoor Ministries*

**Experience Adventure**







**CAMP PERKINS**  
*Lutheran Outdoor Ministries*

**Experience Belonging**





**CAMP PERKINS**  
*Lutheran Outdoor Ministries*

**Experience Christ**



**STAFF | Developing Kingdom Workers**



**CAMP PERKINS**

*Lutheran Outdoor Ministries*

Regional Round Ups  
Delegate Goals  
Congregational  
Commitment Form

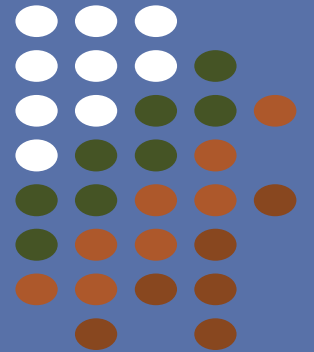

## Delegate Resources

Congratulations on being selected to serve as your congregation's delegate to Camp Perkins. This page is designed to provide resources you will need to fulfill your role as a delegate. Please download the documents or reports you need. Check back regularly for updated and new information. May God guide you in carrying out these duties and bless your work. Thank you for serving Camp Perkins!

[REGISTER FOR THE 2023 DELEGATE CONVENTION!](#)

- **Convention Materials** (Nomination Info, Delegate Commitment Form, Minutes, Reports, etc.)
- **Contact Information** (Board and Delegates)
- **Promo Videos to download**
- **Bulletin Inserts and Flyers**



[www.campperkins.org/delegates](http://www.campperkins.org/delegates)

## Delegate Resources page

## Communication: Bi-monthly Emails





**CAMP PERKINS**

*Lutheran Outdoor Ministries*

# Director Updates

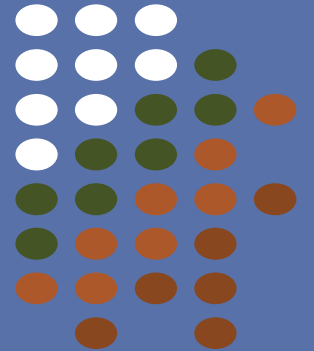

# Summer Camp / Retreats / Hosted

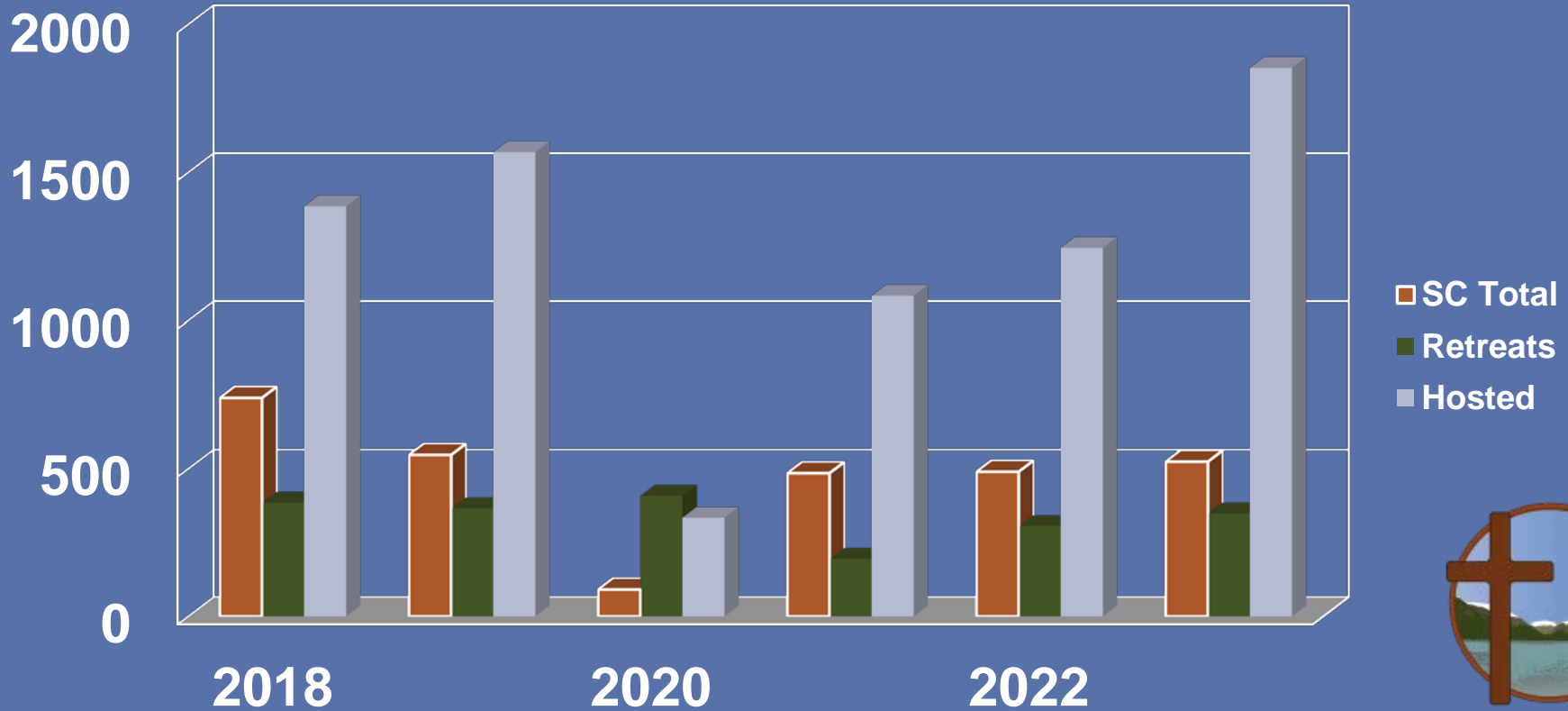
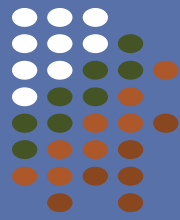

# Summer Camp

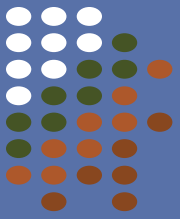

2022

- 490 campers out of an 800 camper capacity.
- Reduced numbers due to national staffing shortage.

2023

- 524 campers! Space for 190 more! Fully Staffed!





2022 Ross Fork  
Fire Evacuation –

Kept safe from fire  
by the grace of God

# New Winter Snow Coach in Action!





**CAMP PERKINS**

*Lutheran Outdoor Ministries*

# Finance Committee

Ben Anderson, Treasurer

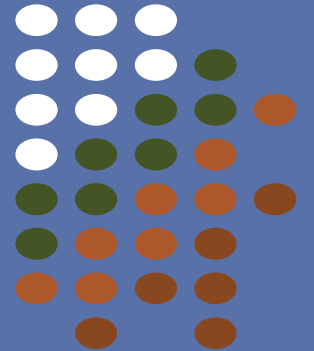

# 2022 Financial Report

(June 2023 Delegates Retreat)



## Camp Perkins Financial Ratios

	2014	2015	2016	2017	2018	2019	2020	2021	2022
Income to Expense	1.19	1.16	1.21	1.04	1.25	1.27	1.16	1.91	1.14
Labor to Sales	2.10	2.23	2.18	1.91	2.02	2.34	2.03	3.22	1.89
Program Expense to Sales	1.61	2.11	2.10	2.26	3.07	1.43	0.53	2.68	2.20
Donations Year over Year	1.49	0.72	1.27	1.02	1.23	1.49	0.91	1.75	0.63
Fee Income Year over Year	1.21	1.05	1.19	0.79	1.00	1.00	0.35	0.64	1.90
Program Income Year over Year	0.99	1.19	0.98	1.04	1.23	0.84	0.25	0.81	1.10

\*ratioed with 2019

# Camp Perkins Financial Ratios

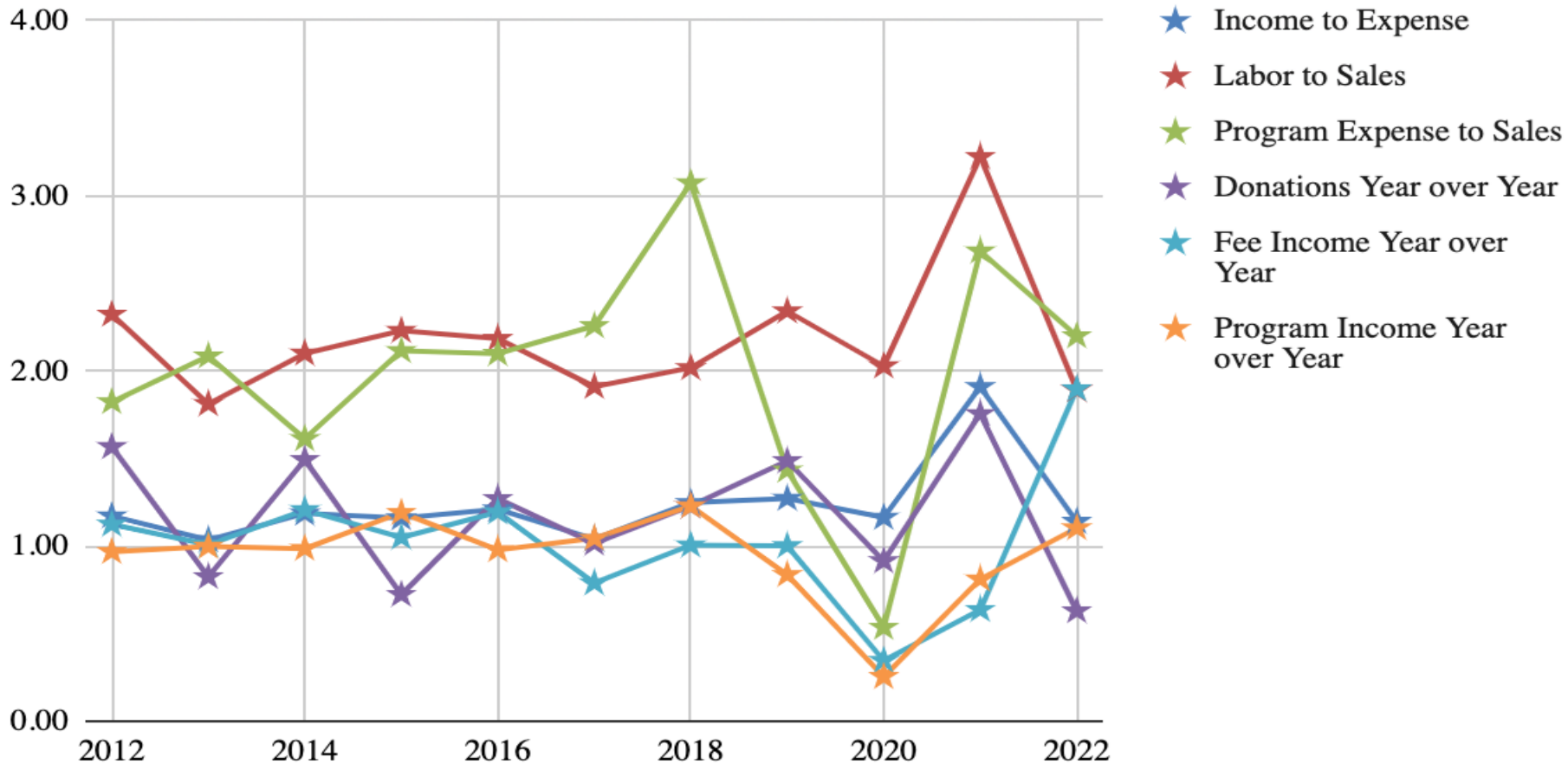

# Income

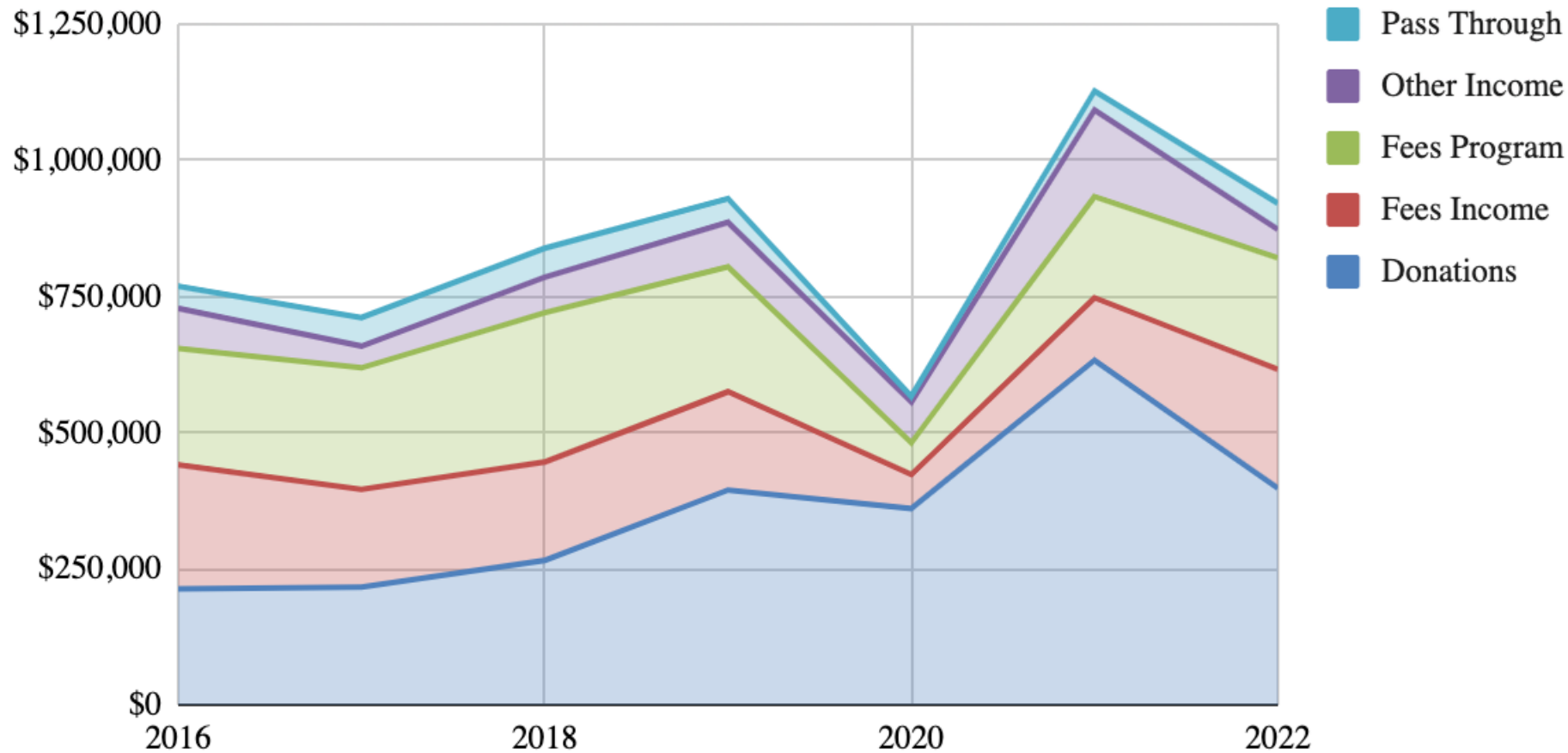

# Fee & Program Income

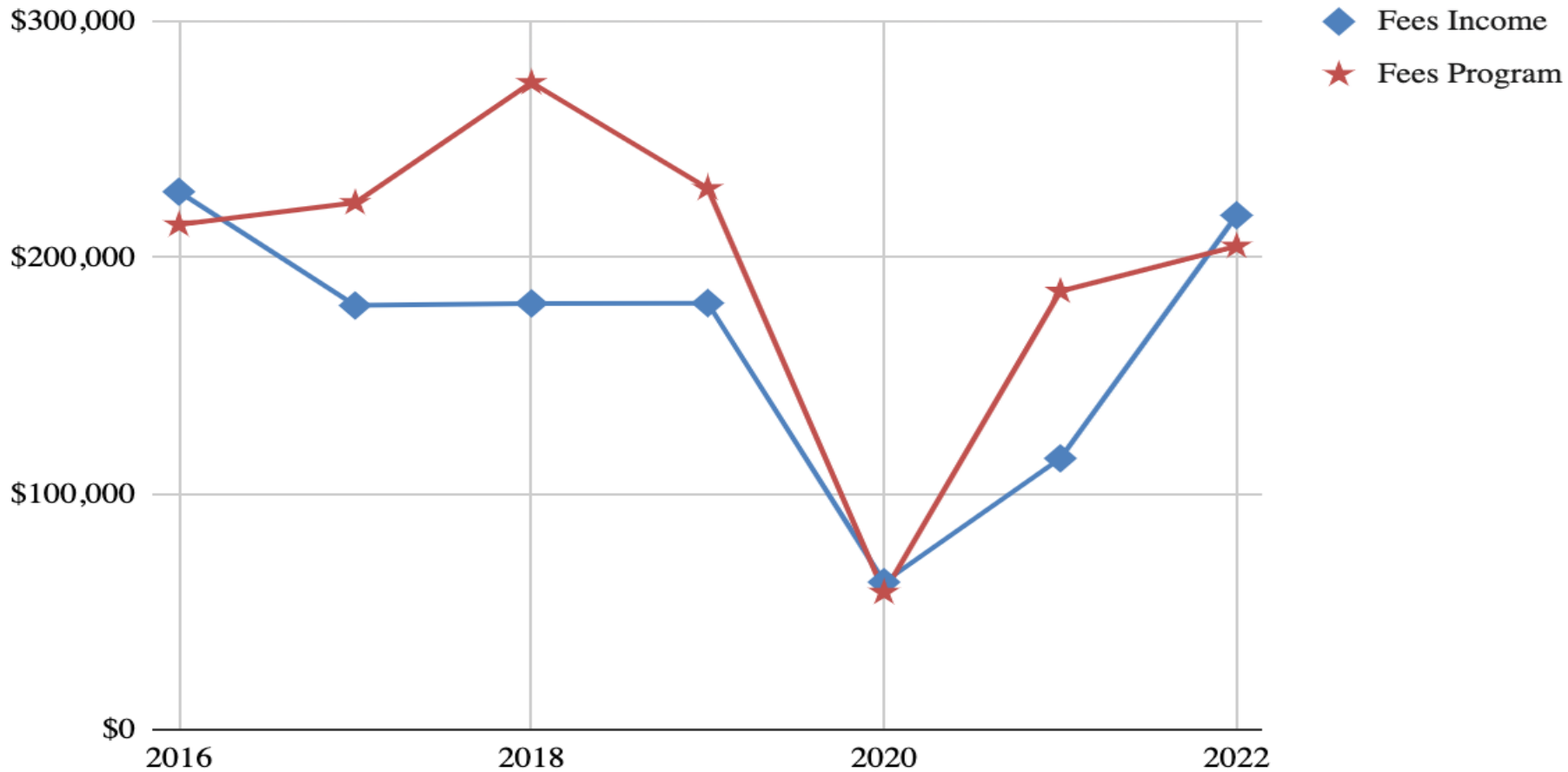

# Expenses

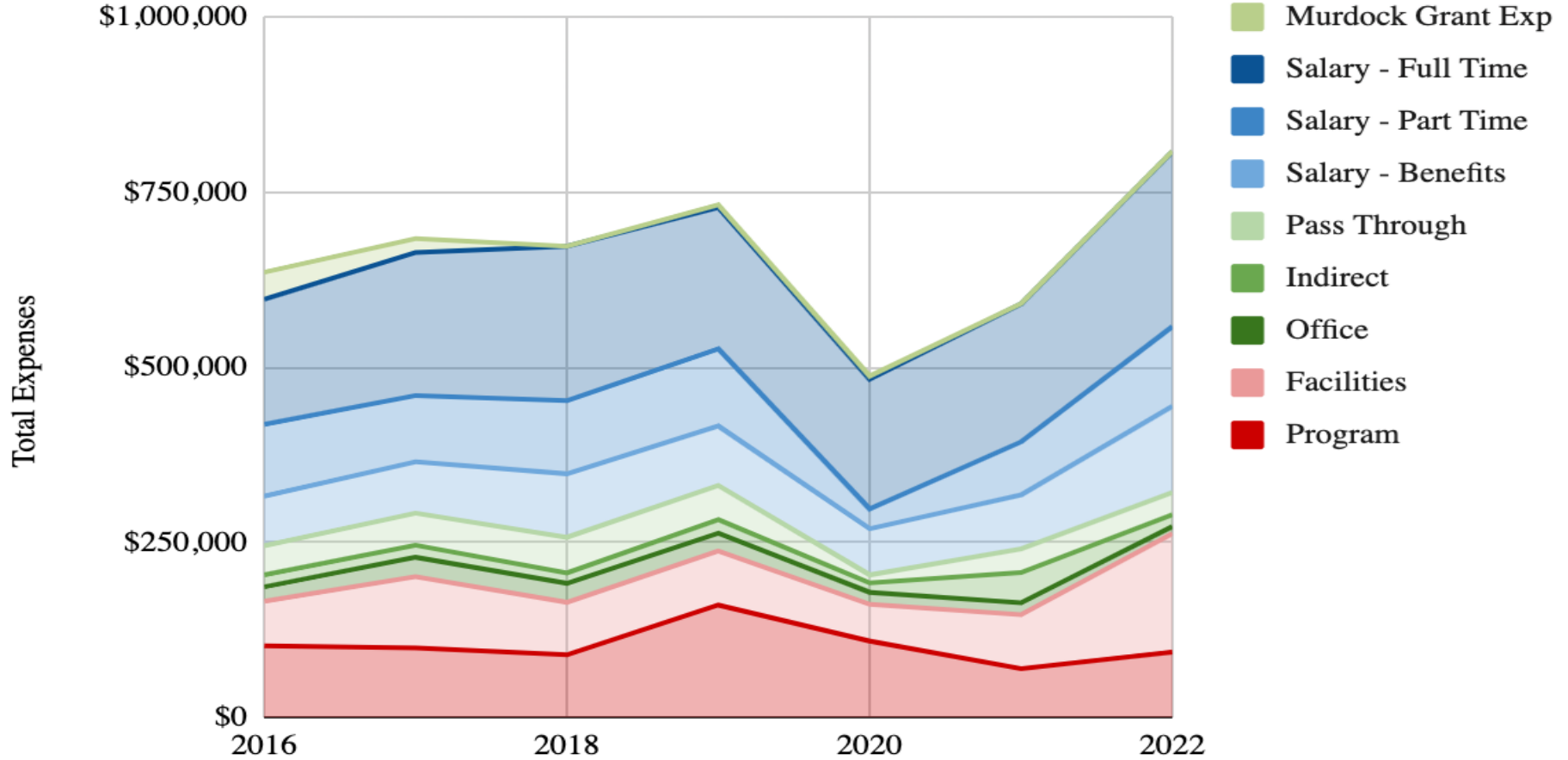



**CAMP PERKINS**  
*Lutheran Outdoor Ministries*

# Financial Development

Kim Morgan

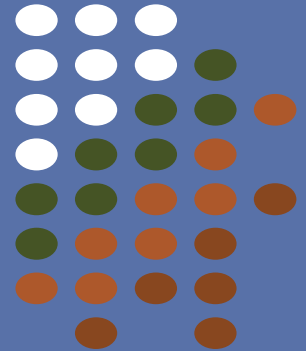

# Rental Pricing Change

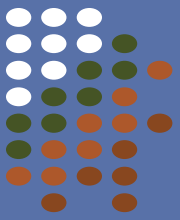

- From per person price to per room/cabin price
- Goals:
  - Promote more efficient use of lodging space
  - Simplify pricing
- Rates for different group types, like youth or family
- Discounts for Christian ministries, member congregations, longer stays, weekdays





# Celebration: 2022 Matching Challenge

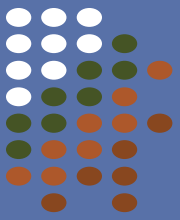

- Fall 2022 Matching Challenge of \$50,000
- Goal: Raise another \$50k from community, for a total of \$100,000
- Funds for Vehicle Fund, FTCF camperships, and Income loss from fire
- Result: Raised additional \$80,000, surpassing the goal for a total of \$130,000



# 2023 True Cost of Camp Campaign

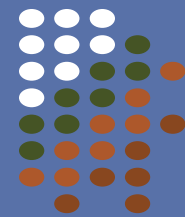

- True Cost of Camp: \$150,000 gap (500 campers)
- Goal: Raise \$130,000 with summer campaign (cover 433 campers)
- Challenge of \$65,000 from several families
- Goal to raise the additional \$65k from camp community
- Delegate challenge



# TRUE COST OF CAMP

Delegate and Board Challenge

\$2500 Match... ~ \$100/person





**CAMP PERKINS**  
*Lutheran Outdoor Ministries*

What's next?  
Master Development  
Plan

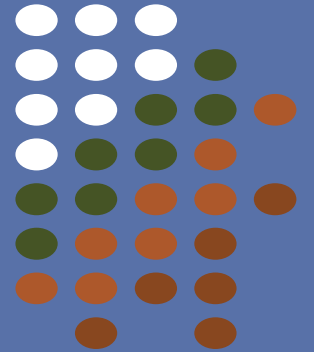



# Celebrate!

- ❑ Memorandum of Agreement signed by SHPO, USFS, CPLOM
- ❑ Camp Perkins is a priority for the Sawtooth National Forest, not just the SNRA
- ❑ USFS Specialists coming this summer to review their areas and work towards a Categorical Exclusion
- ❑ Public Scoping will likely take place this summer (notice in the paper for public comment and interested parties to receive a letter)

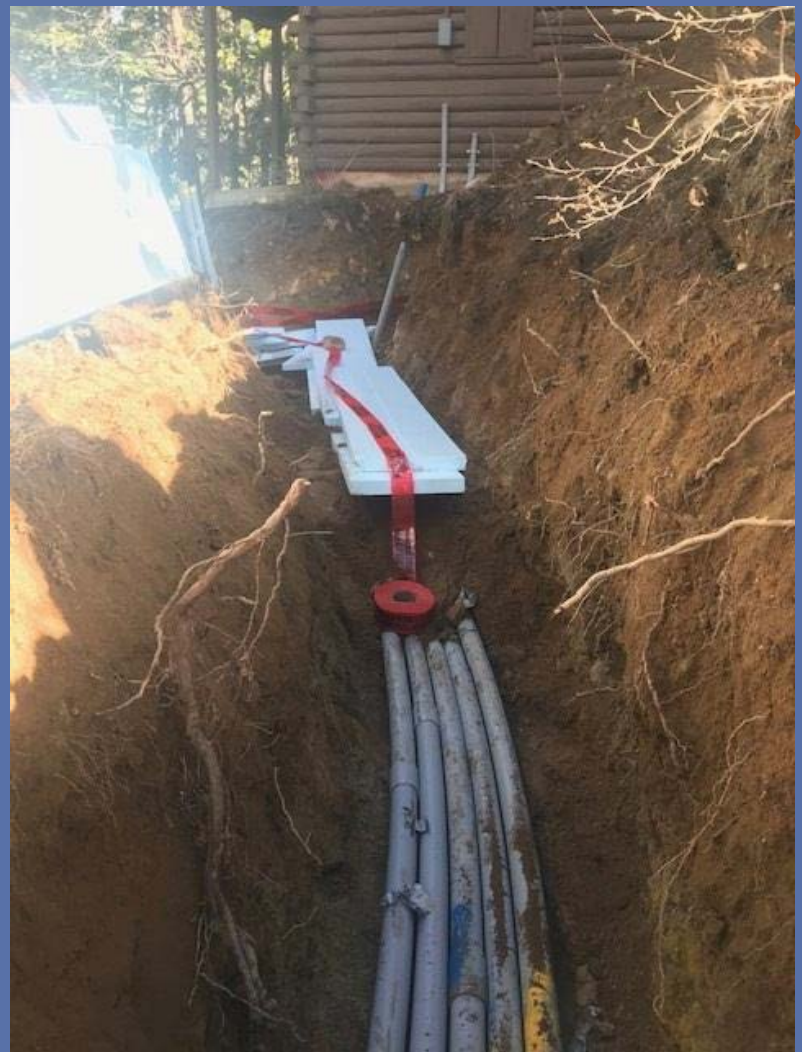



**Cabins 1 & 2**  
**Current**





# Cabins 1 & 2 Mock Up



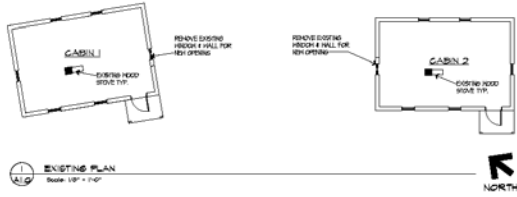

1 EXISTING PLAN  
Scale: 1/8" = 1'-0"



AREA OF WORK

2 KEY PLAN  
Scale: 1/8" = 1'-0"

LEGEND:

- AREA OF EXISTING BUILDING
- AREA OF NEW ADDITION

## Cabin 1 & 2 Addition PERK-01 & PERK-02

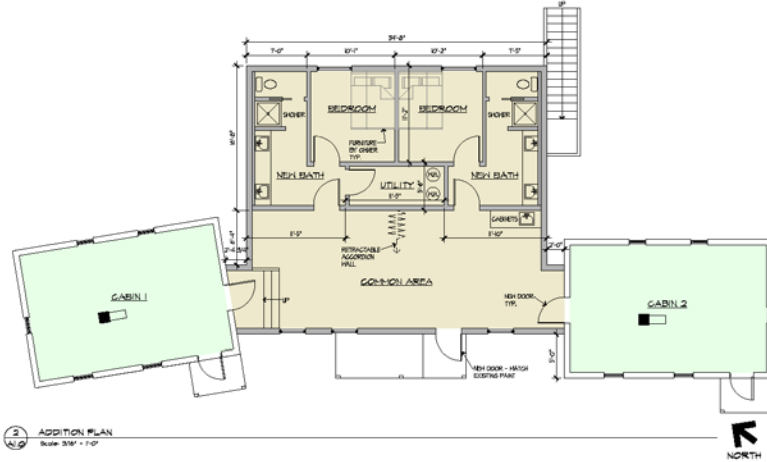

3 ADDITION PLAN  
Scale: 3/16" = 1'-0"

**ROOM FINISHES:**  
**BATHROOMS & BEDROOMS:**  
 HALLS: PAINT ON 6/15PM BD.  
 FLOOR: SEALED CONCRETE TO MATCH EXISTING UPPER FLOOR. HARDWOOD FLOORING UPPER BATHROOM VCT CEILING: PAINT ON 6/15PM BD.  
**EXTERIOR:**  
 HALLS: HALF LOG PINE SIDING - STAIN TO MATCH EXISTING  
 ROOF: PRE-FINISHED METAL ROOFING TO

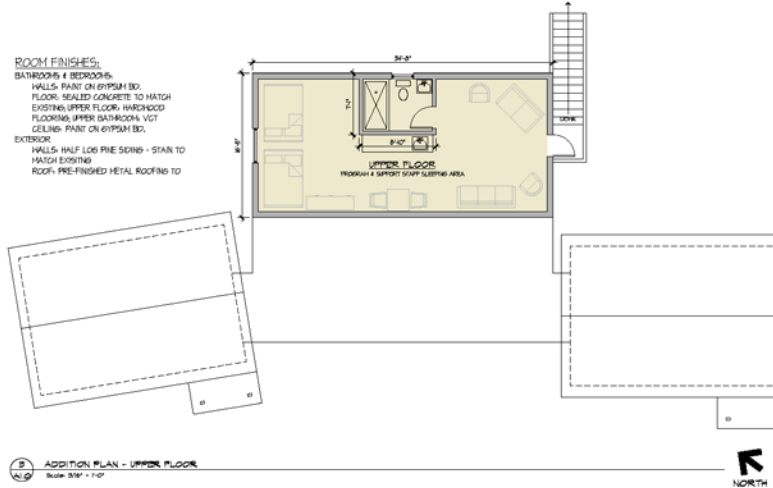

4 ADDITION PLAN - UPPER FLOOR  
Scale: 3/16" = 1'-0"



AT ARCHITECTURE

BUILDING ADDITIONS:  
**CAMP PERKINS LOM**  
 LAKE PERKINS, IDAHO

COPYRIGHT © BY AGENCY  
 This drawing and its contents are the property of AT ARCHITECTURE. No part of this drawing may be reproduced or transmitted in any form or by any means, electronic or mechanical, including photocopying, recording, or by any information storage and retrieval system, without the prior written permission of AT ARCHITECTURE. PROJECT NO. PERK-01 & PERK-02. DATE: 01/28/22

DATE: 01/28/22  
 DRAWN BY: JR  
 CHECKED BY: JRS  
 REVISIONS:

FLOOR PLANS

A1.0

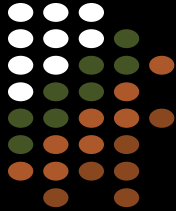

# Cabin 1 & 2 Addition PERK-01 & PERK-02

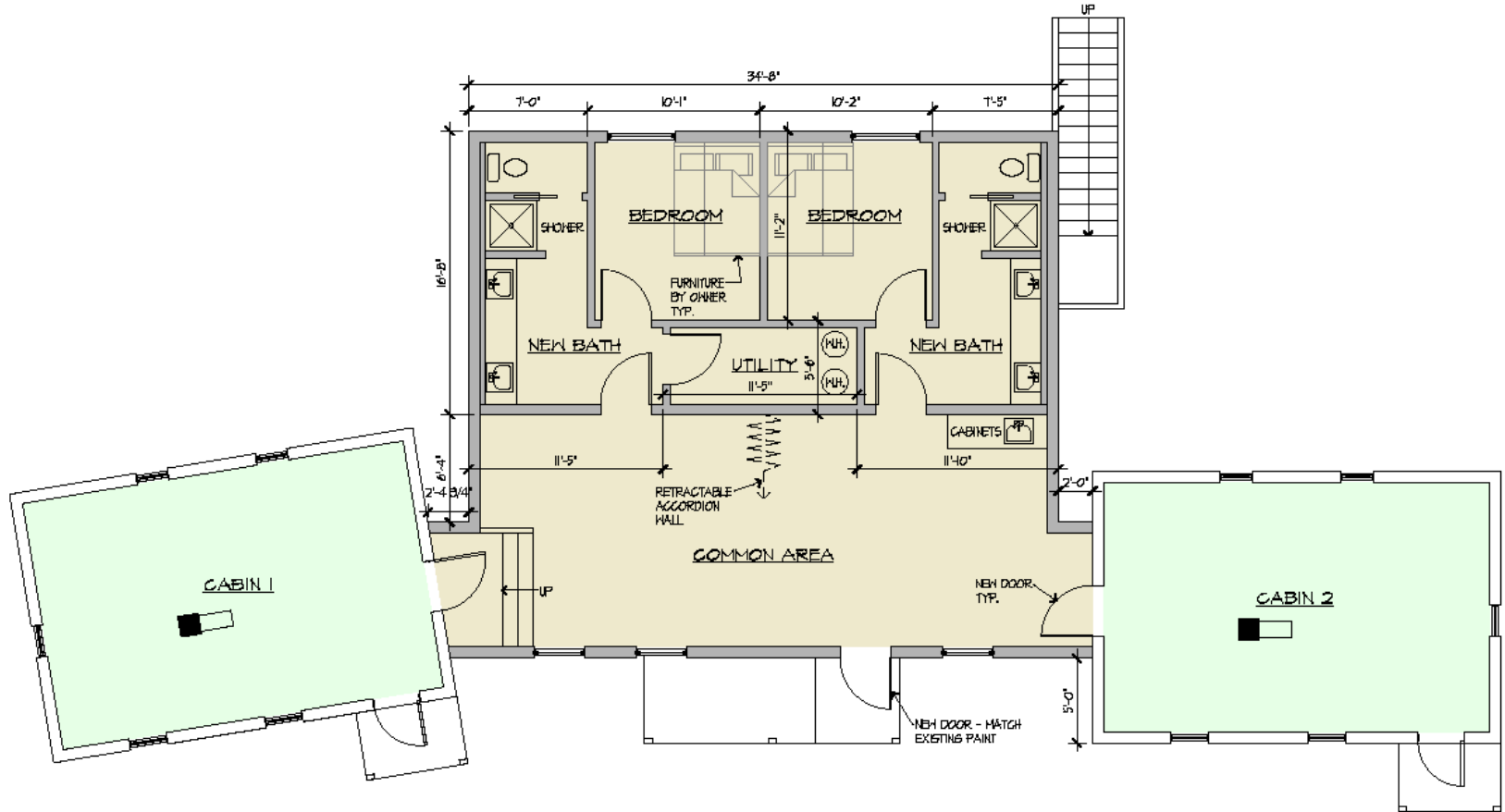

AT ARCHITECT

ADDITIONS:  
**SKINS LOM**



# Cabins 7 & TP





# Cabins 7 & TP

## Mockup

(move back TP to  
combine with Cabin 7)



# Cabin 7 & Trading Post Addition PERK-07 & PERK-21



**BUILDING ADDITIONS:**  
**CAMP PERKINS LOM**  
 LAKE PERKINS, IDAHO

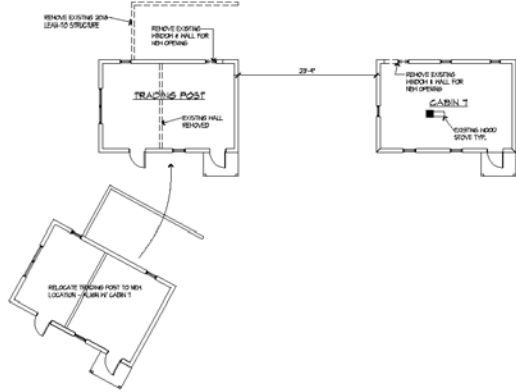

1  
A1.0 EXISTING PLAN  
Scale: 3/8" = 1'-0"

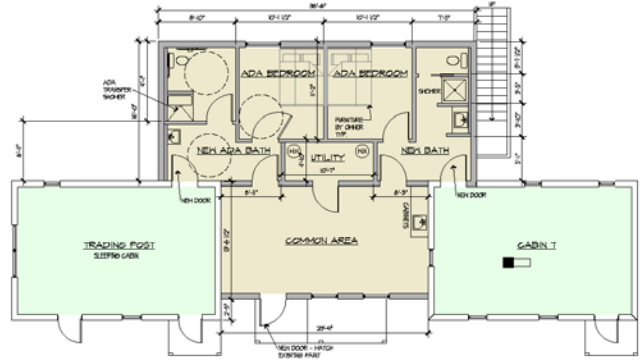

2  
A1.0 ADDITION PLAN  
Scale: 3/8" = 1'-0"



AREA OF WORK

3  
A1.0 KEY PLAN  
Scale: NO SCALE



**ROOM FINISHES:**  
 BATHROOMS & BEDROOMS:  
 HALLS: PAINT ON 6/15PM BD.  
 FLOOR: SEALED CONCRETE TO MATCH EXISTING.  
 UPPER FLOOR: HARDWOOD FLOORING.  
 UPPER BATHROOM: VCT GELURA. PAINT ON 6/15PM BD.  
 EXTERIOR:  
 HALLS: HALF LOG-PINE SIDING - STAIN TO MATCH EXISTING.  
 ROOF: PRE-FINISHED METAL ROOFING TO MATCH EXISTING.

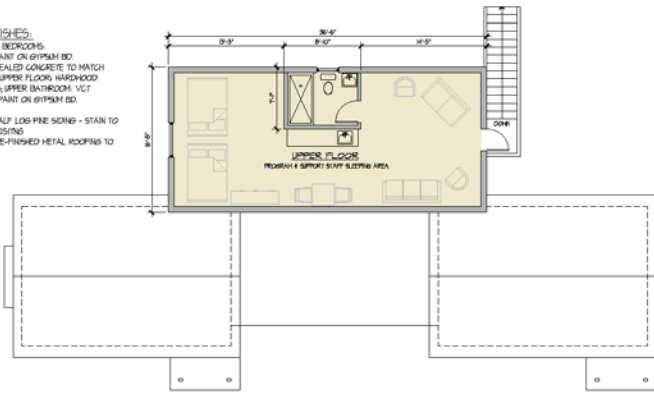

4  
A1.0 ADDITION PLAN - UPPER FLOOR  
Scale: 3/8" = 1'-0"



**LEGEND:**

- AREA OF EXISTING MODEL
- AREA OF NEW ADDITION

**COPYRIGHT STATEMENT:**  
 THIS DOCUMENT IS THE PROPERTY OF AT ARCHITECTURE. IT IS TO BE USED ONLY FOR THE PROJECT AND SITE SPECIFICALLY IDENTIFIED HEREIN. NO PART OF THIS DOCUMENT IS TO BE REPRODUCED, STORED IN A RETRIEVAL SYSTEM, OR TRANSMITTED IN ANY FORM OR BY ANY MEANS, ELECTRONIC OR MECHANICAL, INCLUDING PHOTOCOPYING, RECORDING, OR BY ANY INFORMATION STORAGE AND RETRIEVAL SYSTEM, WITHOUT THE WRITTEN PERMISSION OF AT ARCHITECTURE.

DATE: 01/18/20  
 DRAWN BY: JH  
 CHECKED BY: JPS  
 REVISIONS:

FLOOR PLANS

**A1.0**



# Cabin 7 & Trading Post Addition PERK-07 & PERK-21

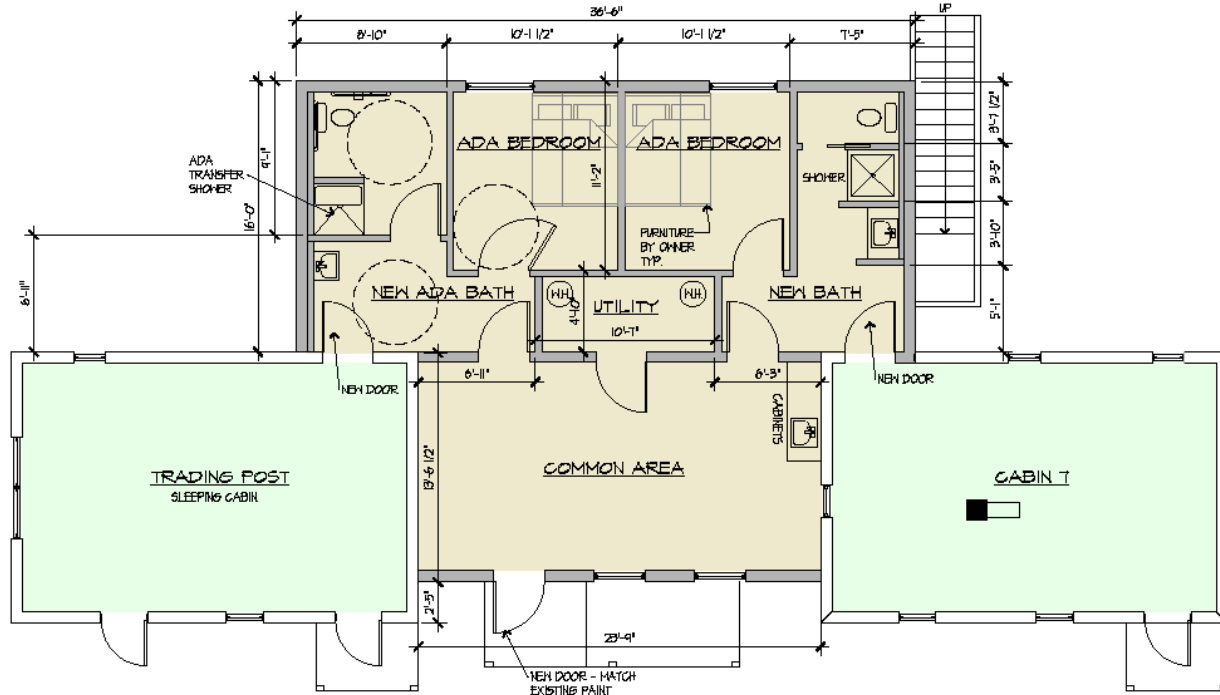

2  
A.I.G.

ADDITION PLAN

Scale: 3/16" = 1'-0"



NORTH



NORTH



AT  
ARCHITECTURE

ADDITIONS:  
PERKINS LOM



# Cabins 9 & 10

## Current





# Cabins 9 & 10

## Mock Up





**Cabin 8 Current**





# Cabin 8

add on 2 bathrooms  
to be the Nurses Quarters  
and Infirmary



# Cabin 8 Addition PERK-08



AT  
ARCHITECTURE

## BUILDING ADDITIONS: CAMP PERKINS LOM LAKE PERKINS, IDAHO

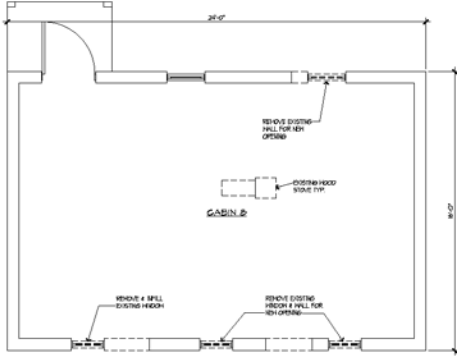
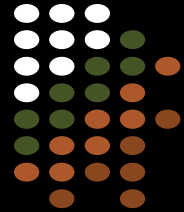

1  
A1.0  
EXISTING PLAN  
Scale: 3/8" = 1'-0"

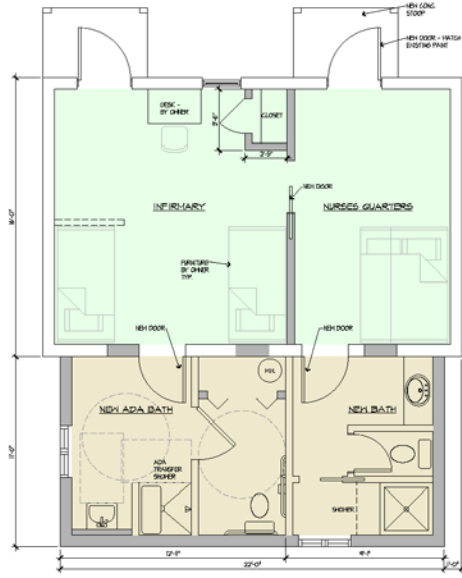

2  
A1.0  
ADDITION PLAN  
Scale: 3/8" = 1'-0"



**ROOM FINISHES:**  
BATHROOMS:  
WALLS: PAINT ON GYPSUM BO.  
FLOOR: SEALED CONCRETE TO MATCH EXISTING  
CEILINGS: PAINT ON GYPSUM BO.  
EXTERIOR:  
WALLS: HALF LOG PINE SIDING - STAIN TO MATCH EXISTING  
ROOF: PRE-FINISHED METAL ROOFING TO

**LEGEND:**

	AREA OF EXISTING BUILDING
	AREA OF NEW ADDITION



AREA OF WORK

3  
A1.0  
KEY PLAN  
Scale: 1/8" = 1'-0"



**COPYRIGHT STATEMENT:**  
THIS DRAWING AND THE DESIGN OF THE BUILDING OR ANY PART OF THE BUILDING ARE THE PROPERTY OF AT ARCHITECTURE. NO PART OF THIS DRAWING OR DESIGN MAY BE REPRODUCED OR TRANSMITTED IN ANY FORM OR BY ANY MEANS, ELECTRONIC OR MECHANICAL, INCLUDING PHOTOCOPYING, RECORDING, OR BY ANY INFORMATION STORAGE AND RETRIEVAL SYSTEM, WITHOUT THE WRITTEN PERMISSION OF AT ARCHITECTURE. © COPYRIGHT 2010, PERKINS & WEE

DATE:	08/12/20
DRAWN BY:	JR
CHECKED BY:	JRS
REVISIONS:	

FLOOR PLANS

**A1.0**

# Cabin 8 Addition PERK-08



AT  
ARCHITECTURE

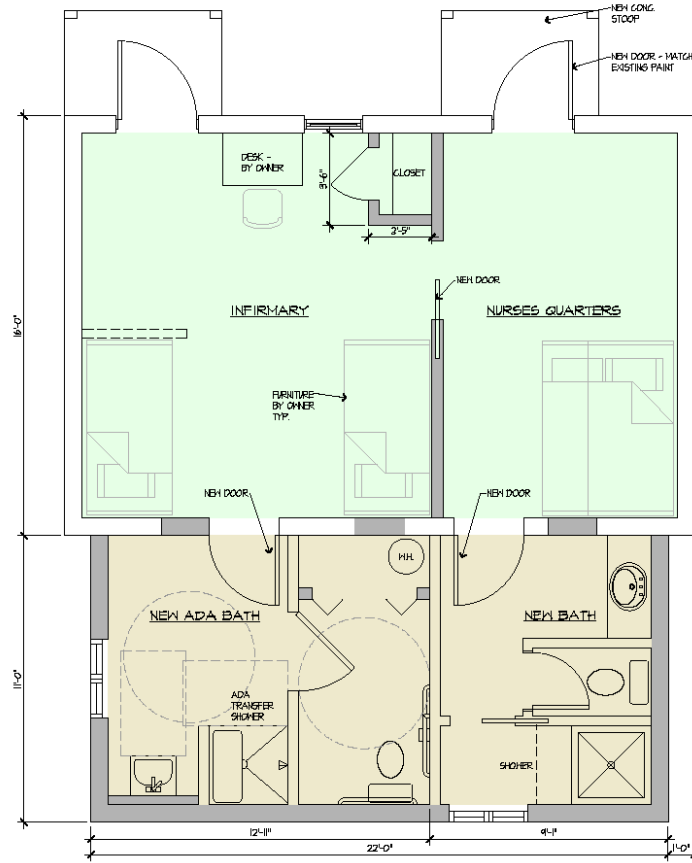

BUILDING ADDITIONS:  
**CAMP PERKINS LOM**

PERKINS, IDAHO



# Lodge Current





Lodge Mockup  
Front





# Lodge Current



# Lodge Mockup Side



# Lodge Addition PERK-13

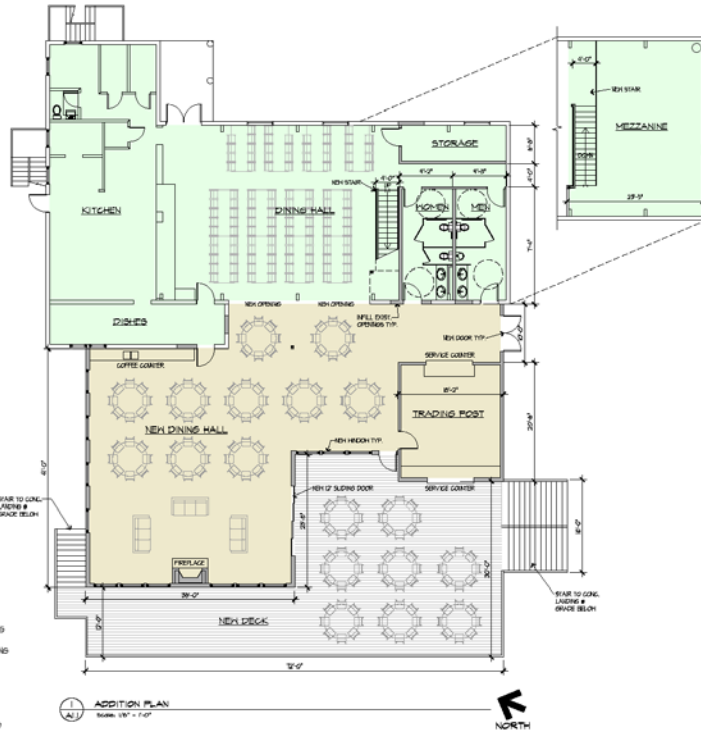
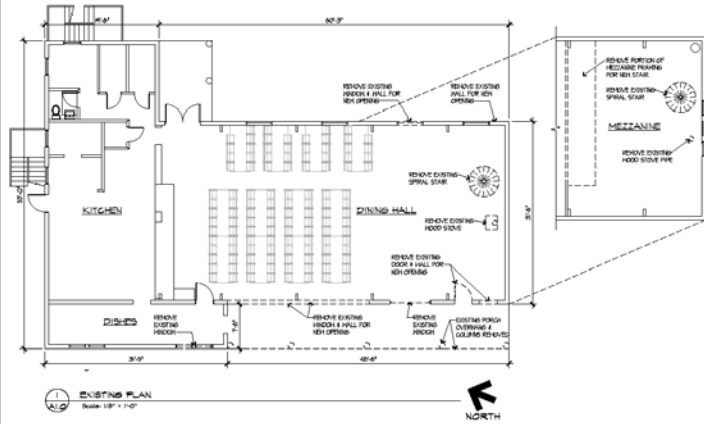

- ROOM FINISHES:**
- TRADING POST**
    - WALLS: PAINT ON GYPSUM BD.
    - FLOOR: VCT TILE TO MATCH EXISTING
    - CEILING: PAINT ON GYPSUM BD.
  - NEW DINING HALL**
    - WALLS: 1/2\" T & 6\" PINE TO MATCH EXISTING
    - FLOOR: CONCRETE TO MATCH EXISTING
    - CEILING: 1/2\" T & 6\" PINE TO MATCH EXISTING
  - RESTROOMS**
    - WALLS: PAINT ON GYPSUM BD./ CERAMIC TILE UP 40"
    - FLOOR: VCT TILE TO MATCH EXISTING
    - CEILING: PAINT ON GYPSUM BD.
  - EXTERIOR**
    - WALLS: HALF LOG PINE SIDING - STAIN TO MATCH EXISTING
    - ROOF: PRE-FINISHED METAL ROOFING TO MATCH ADJACENT BUILDINGS
  - DECK**
    - REDWOOD 2x4 DECKING & RAILING STAIN TO MATCH EXISTING



BUILDING ADDITIONS:  
**CAMP PERKINS LOM**  
LAKE PERKINS, IDAHO

© COPYRIGHT BY A PERKINS  
THIS DRAWING IS THE PROPERTY OF  
LAKE PERKINS LOM AND IS NOT TO BE  
REPRODUCED OR COPIED IN ANY  
MANNER WITHOUT THE WRITTEN CONSENT OF A1.1  
PERKINS ARCHITECTURE, P.C.  
REVISED: 4/18

DATE:	10/07/20
CREATED BY:	JR
REVISIONS:	

FLOOR PLANS  
**A1.1**

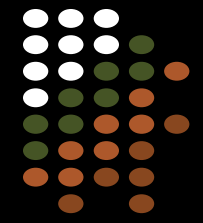





# Director's Cabin Addition PERK-17

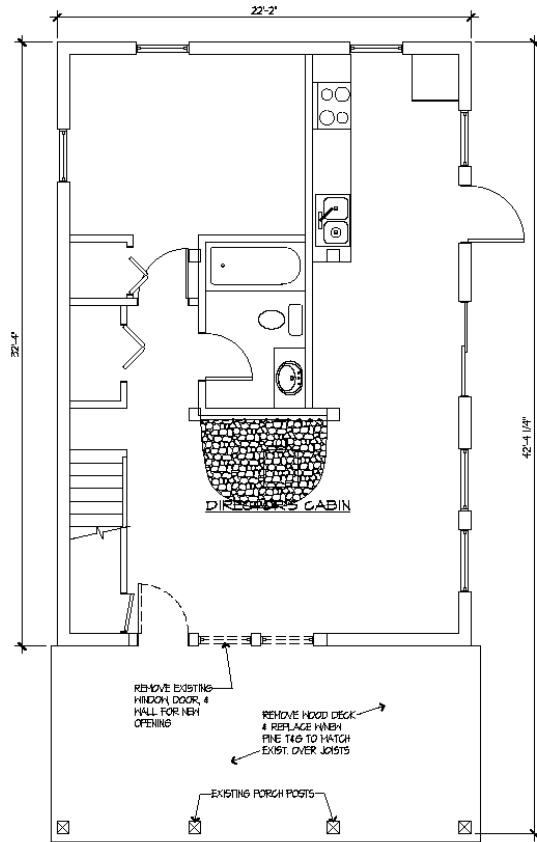

1 EXISTING PLAN  
Scale: 1/4" = 1'-0"

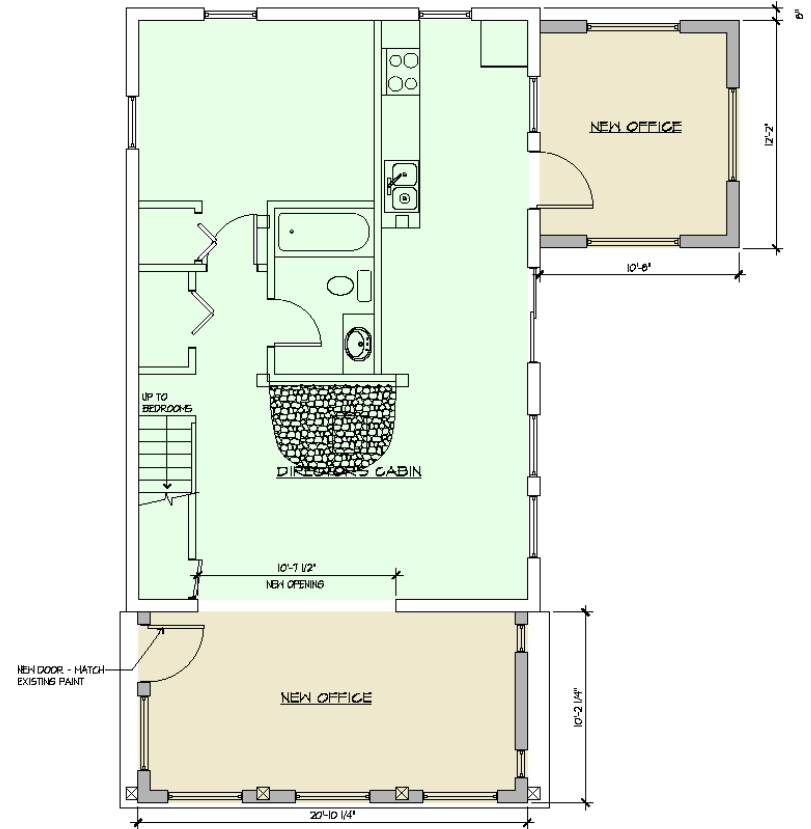

2 ADDITION PLAN  
Scale: 1/4" = 1'-0"



# New Family Duplex Cabin



AT ARCHITECT

BUILDING ADDITIONS:  
**P PERKINS LOM**

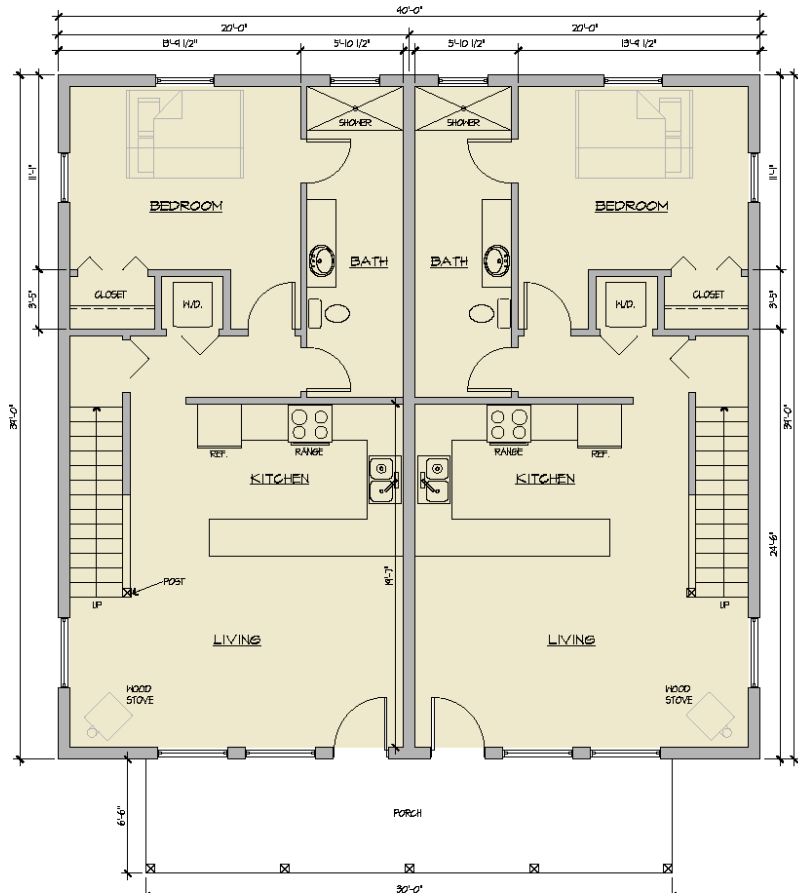
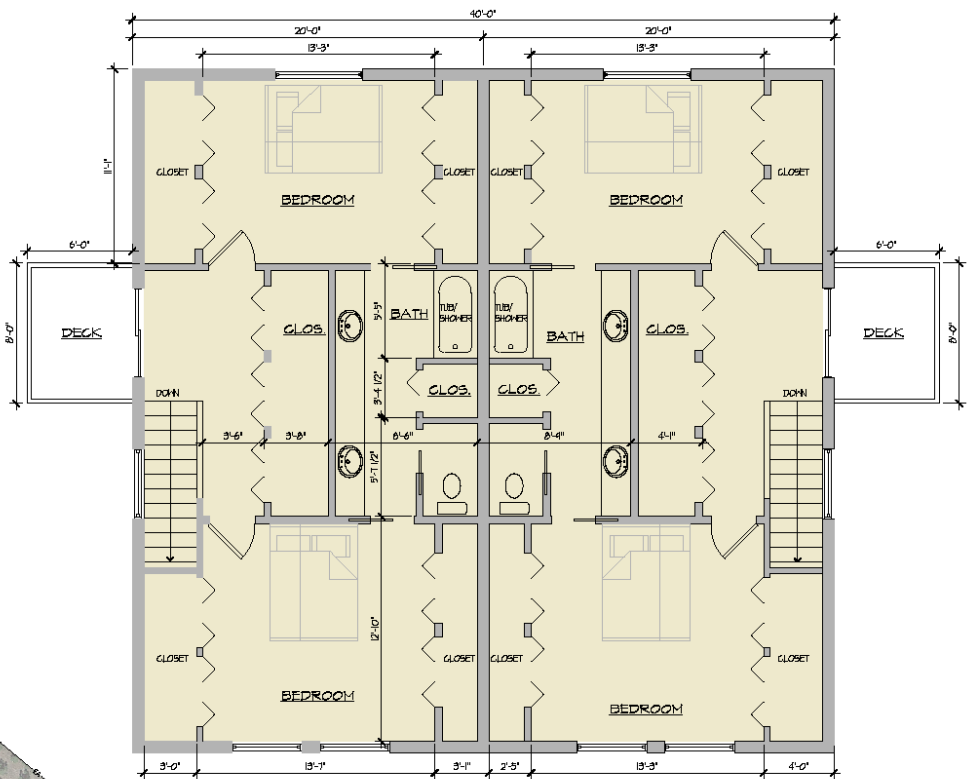

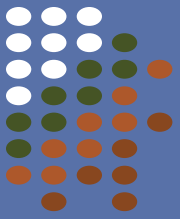

THANK YOU!

*“I will make  
your children  
after you as  
many  
as the stars  
in the sky. And  
I will give them  
all these lands.  
All nations on  
earth will be  
blessed  
because of  
your children.”  
~Genesis 26:4*